

**OAK HILLS RECREATION CENTER**  
**BEAVERTON, OR 97006**

ARCHITECTURAL SCHEME OPTION

Date: 10.14.2014

**HOWELLS ARCHITECTURE + DESIGN LLC**

Scale: 1" = 30'-0"

**A**

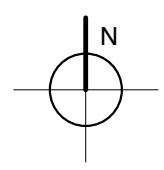
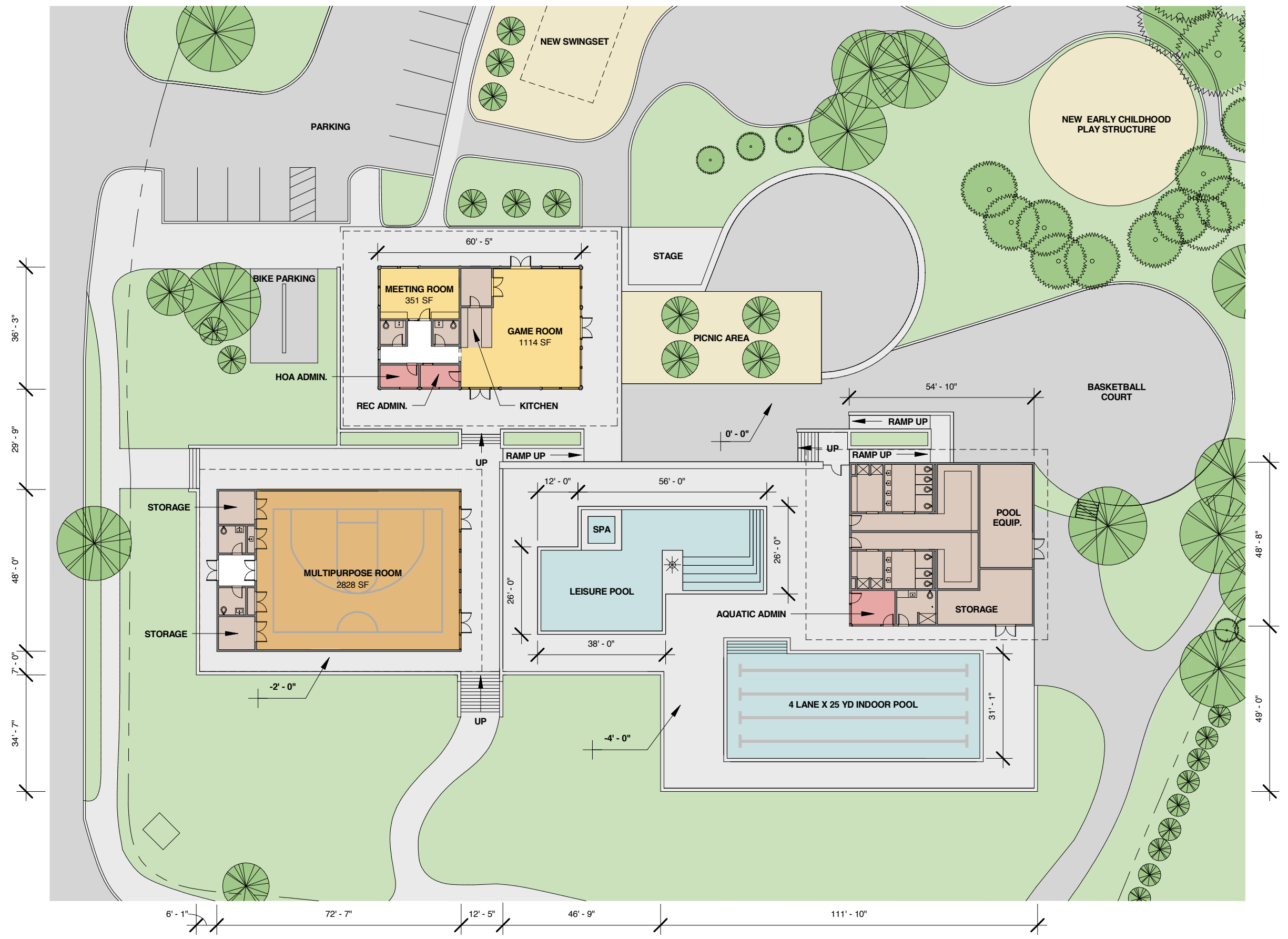

**OAK HILLS RECREATION CENTER**  
**BEAVERTON, OR 97006**

ARCHITECTURAL SCHEME OPTION

Date: 10.14.2014

Scale: 1" = 30'-0"

**HOWELLS ARCHITECTURE + DESIGN LLC**

**B**

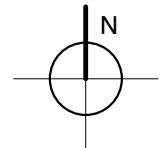
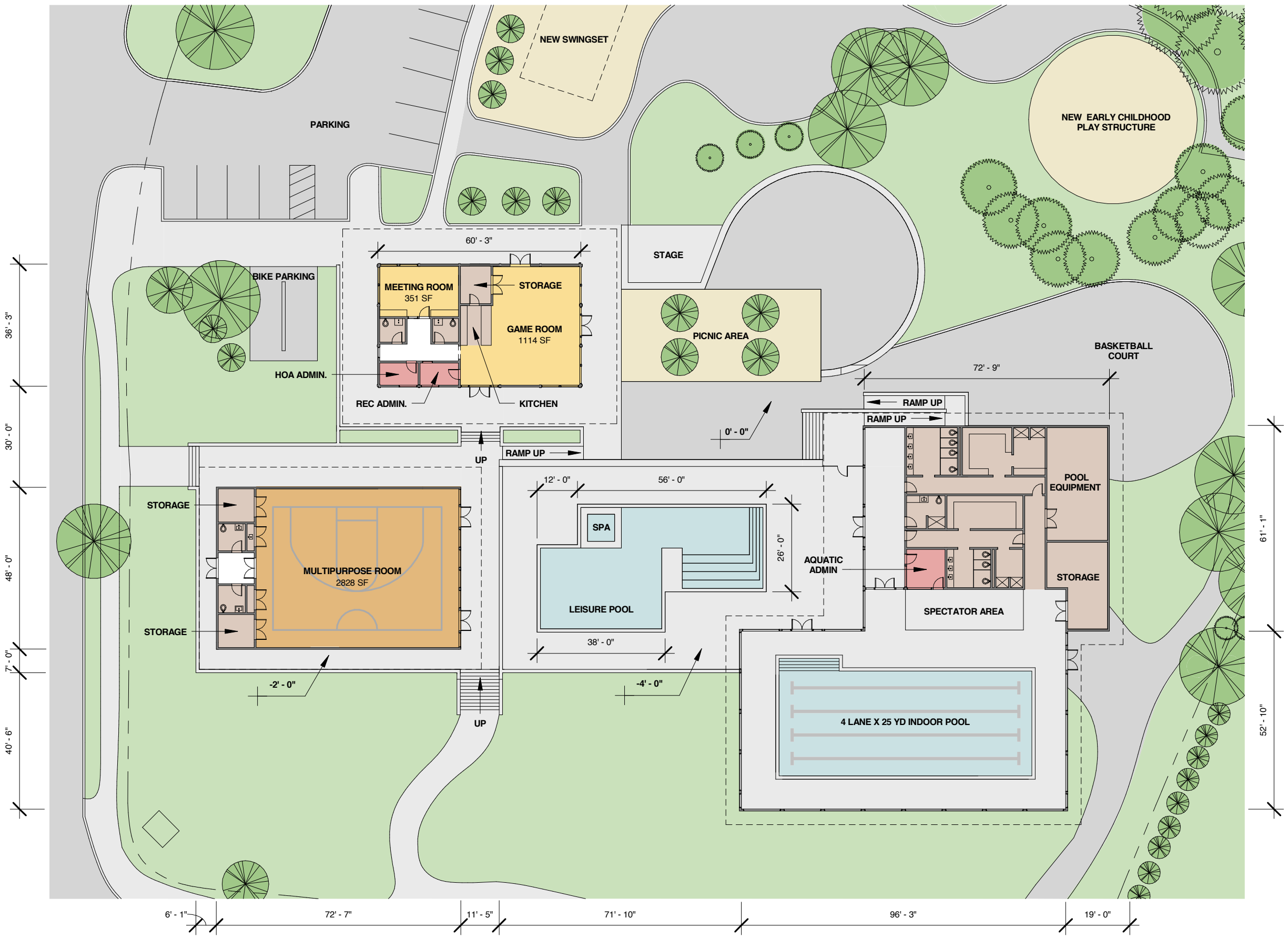

**OAK HILLS RECREATION CENTER**  
**BEAVERTON, OR 97006**

ARCHITECTURAL SCHEME OPTION

Date: 10.14.2014

**HOWELLS ARCHITECTURE + DESIGN LLC**

Scale: 1" = 30'-0"

**C**

**OAK HILLS HOME OWNERS ASSOCIATION**  
**MEMO**

At the October 1, 2014 Board Meeting, the Oak Hills Board of Directors voted to commission drawings to represent the recent Survey Options 3 and 4. These drawings (enclosed) were presented to the Board of Directors at the October 15<sup>th</sup>, 2014 Board Meeting. The Board subsequently agreed to obtain ballpark cost estimates for each of these three options. The intention of the Board is to put these three design options, including construction cost, operational cost, possible income opportunity and financing options, back out to the community in another survey. The results of that survey will inform the Board's decision about which design option will be taken through architectural Schematic Design, used for construction bidding and negotiated financing, and which design option will ultimately be presented to the community for a vote.

*NOTE: These designs are NOT final. These are proposed drawings and will change based on community and Board feedback.*

---